

50-K-57 - SPEEDLINE System Data Sheet - Version V1 (24-10-23)

SPEEDLINE 50mm 'C' Stud Partition @600mm Ctrs,
with 2x Knauf 12.5mm Wallboard each side

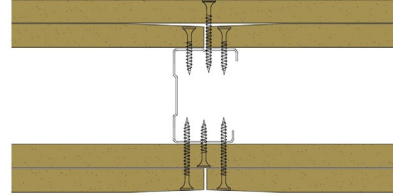

System Performance Breakdown

Fire Resistance:

BS476 Part 22:1987:

Test Ref & Date or Applied Ref & Report:

Max Height:

Thickness:

Duty Grade: BS 5234: Part 2:1992:

Sound Insulation:

60/60 Minutes (Integrity/Insulation).

BRE 208596 - BRE Report P102396-1011B

Refer to Speedline Specification Clause

102 mm. (At Base Track, Excluding Finishes)

Severe - Annexes A-F

42 R_wdB, Date Tested or Assessed Against - 16/06/2011

Test Code:
H17386CA
Test Date:
16/06/2011

Freq. Hz	R dB
50	21.7
63	17.0
80	14.2
100	13.0
125	15.4
160	29.1
200	30.7
250	32.2
315	34.7
400	40.4
500	46.8
630	48.4
800	51.6
1 000	53.5
1 250	56.3
1 600	59.2
2 000	59.3
2 500	50.1
3 150	46.1
4 000	51.5
5 000	53.5
6 300	
8 000	
10 000	

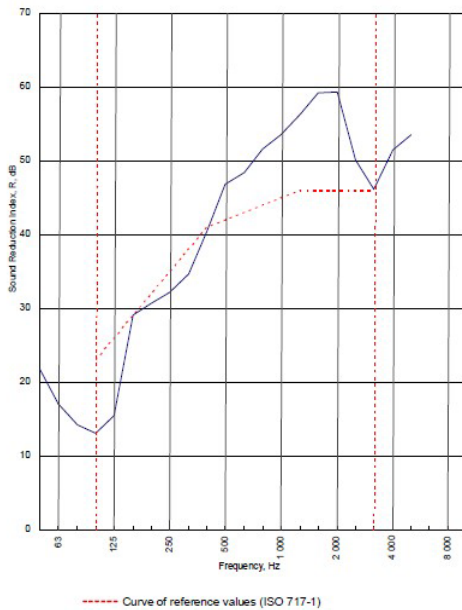

Rating according to
BS EN ISO 717-1:1997

R_w (C;Ctr) = 42 (-4;-11) dB

Max dev. 10.6 dB at 125 Hz

Evaluation based on laboratory
measurement results obtained by
an engineering method:

C₅₀₋₁₁₅₀ = -5 dB C₅₀₋₅₀₀₀ = -4 dB C₁₀₀₋₅₀₀₀ = -3 dB
C₀₋₅₀₃₁₅₀ = -13 dB C₀₋₅₀₄₃₀₀₀ = -13 dB C₀₋₁₀₀₋₄₅₀₀₀ = -11 dB

TESTED AT ONE OF THE UKAS
ACCREDITED LABORATORIES
BELOW

B.T.C
(H-Ref on Graph)



B.R.E



AIRO



S.R.L



Customer: **Metsec plc Hepsec Division**

BTC 17407A: Page 8 of 10



SPEEDLINE Drywall Systems, Adsetts House, 16 Europa View, Sheffield Business Park, Sheffield, S9 1XH.

Tel: 0114 231 8030.

Email: enquiries@speedlinedrywall.co.uk

(As per the requirements set out in ISO/IEC 17025:2017 regarding test data the results stated have been carried out by voestalpine Metsec plc as part of the contract to supply Speedline Metal Sections to SIG Plc)